

Fluid Power Technology

NVQ Level 5 Semester I Examination

Engineering Drawing - E40C00M01

Instructions to Candidates:

Answer **question 01** in **SECTION I**, any one (01) question from **SECTION II** and any one (01) question from **SECTION III**.

Time: 03 hours

Total Marks: 100

SECTION I

- Figure 01 shows the details of a Hardy Spicer universal joint. Assemble the different parts in their correct places in the front elevation of the universal joint.

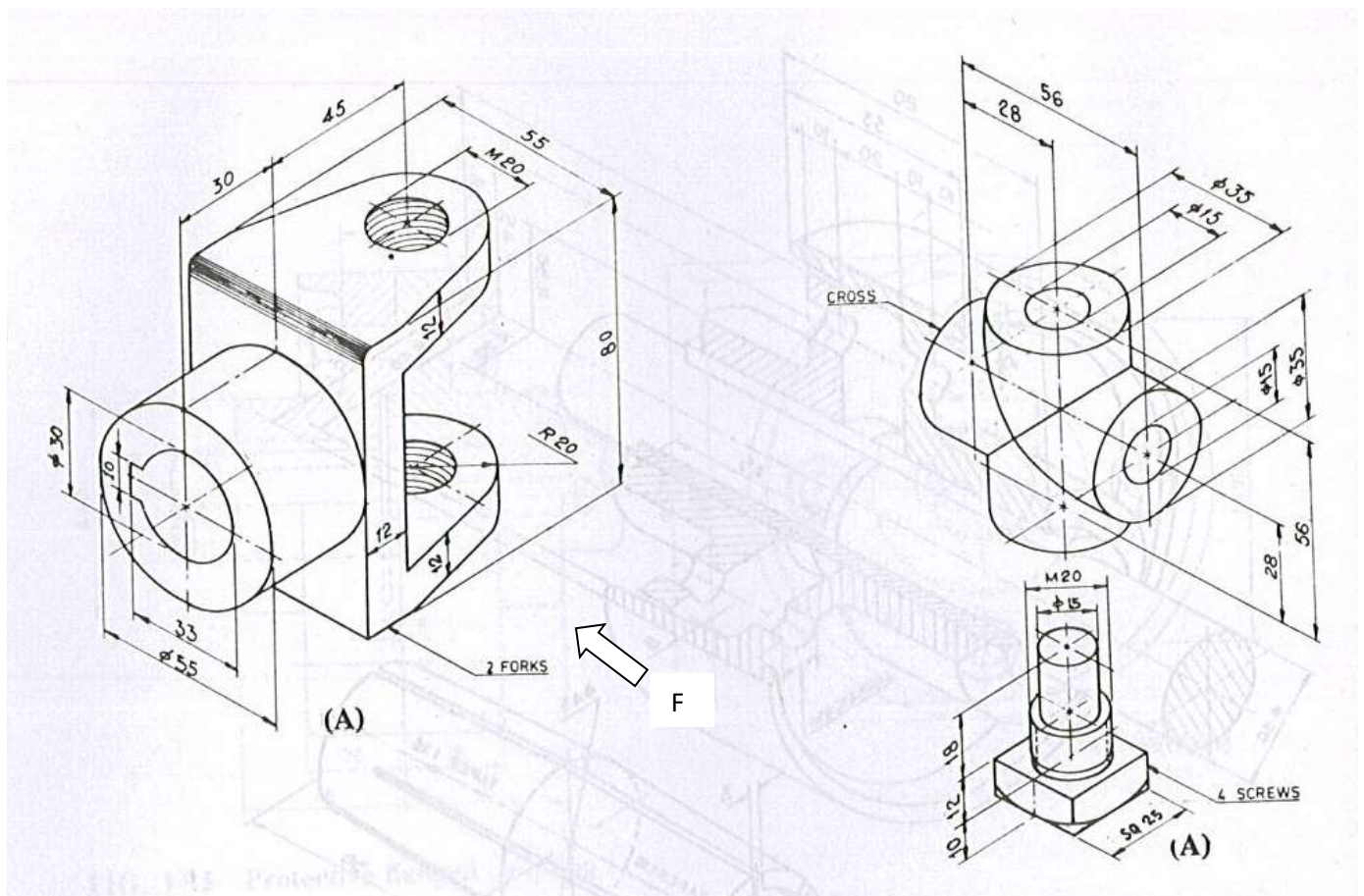

Figure 01

(50 Marks)

SECTION II

If you were asked to produce the given Figure 02 **OR** Figure 03 drawings “CRANK PULLEY/ENGINE PISTON” using Auto CAD, write down briefly in point form how you would prepare the drawing environment.

02.

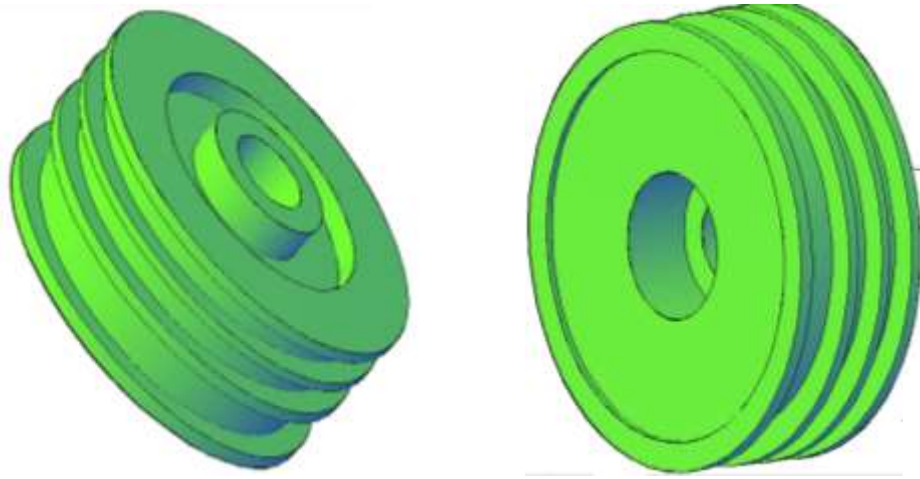

Figure 02

(25 Marks)

03.

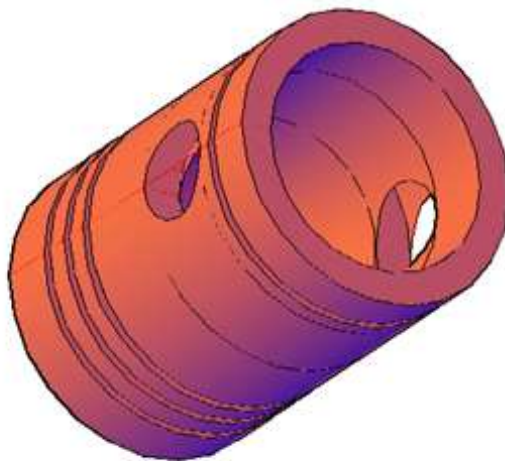

Figure 03

(25 Marks)

SECTION III

Draw the intersection lines of the front view of the following objects and develop the inclined parts of the objects

04.

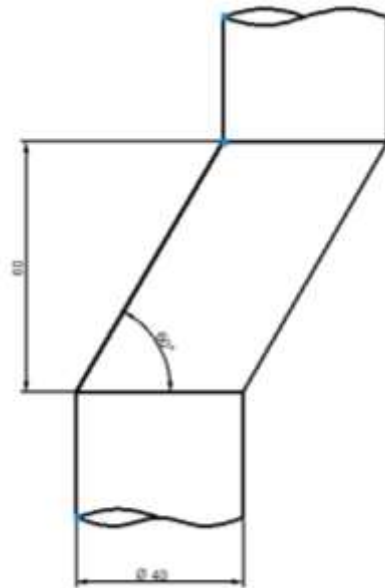

Figure 04

(25 Marks)

05.

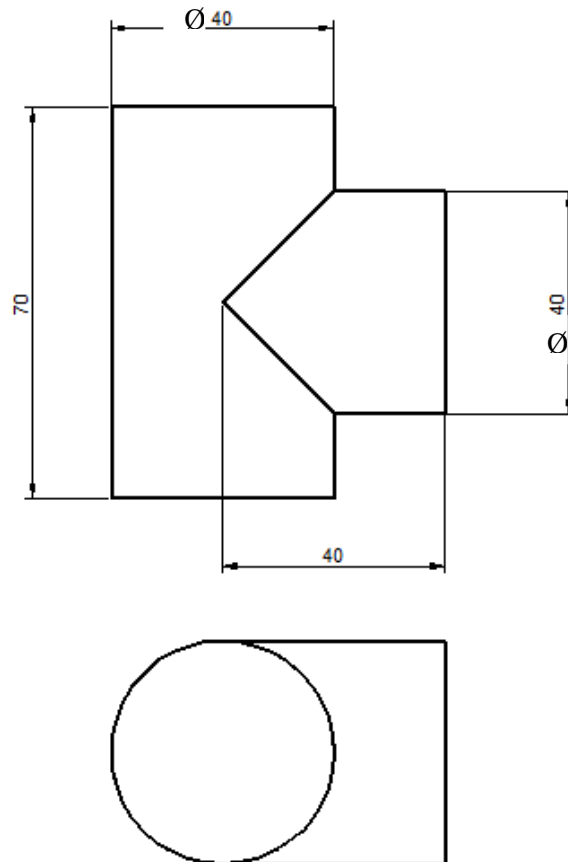

Figure 05

(25 Marks)